

BEISIT®

Кабельные вводы CABLE GLAND

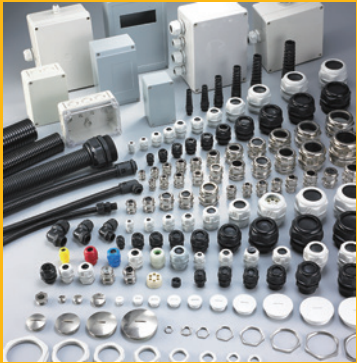

Первый производитель с полным ассортиментом кабельных вводов UL одобрен в Китае

Первый производитель подал заявку на европейский патент на кабельные вводы в Азии

Первый производитель с немецким сертификатом VDE для кабельных вводов в Китае

Первый производитель, прошедший тестирование IP69K в Азии

Пластиковый кабельный ввод тип М M Type Nylon Cable Glands



Материал: PA (NYLON), UL 94 V-2
Уплотнение: NBR, (EPDM, TPV, силикон)
Кольцо: EPDM
Температура: -40 C to 100 C
Цвет: Серый(RAL7035), Черный(RAL9005), другие цвета по запросу
Под заказ: V0, or F1 материал.

Material: PA (NYLON), UL 94 V-2
Hermetic seal: NBR, (EPDM Upon Request)
O-Ring: EPDM
Temperature: -40 C to 100 C
Color: Grey(RAL7035), Black(RAL9005), other colors customized.

Material options: V0, or F1 can be offered upon request.



| Thread ØD1 | ØK mm | H mm | GL mm | Seal mm | Beisit No. | |
|---------------|----------|---------|----------|------------|------------|----------|
| | | | | | grey | black |
| M12x1,5 | 3-6,5 | 21 | 8 | 15 | M1207 | M1207B |
| M12x1,5 | 2-5 | 21 | 8 | 15 | M1205 | M1205B |
| M12x1,5 | 4-8 | 22 | 8 | 19 | M1208 | M1208B |
| M16x1,5 | 4-8 | 22 | 8 | 19 | M1608 | M1608B |
| M16x1,5 | 2-6 | 22 | 8 | 19 | M1606 | M1606B |
| M16x1,5 | 5-10 | 25 | 8 | 22 | M1610 | M1610B |
| M20x1,5 | 6-12 | 27 | 9 | 24 | M2012 | M2012B |
| M20x1,5 | 5-9 | 27 | 9 | 24 | M2009 | M2009B |
| M20x1,5 | 10-14 | 28 | 9 | 27 | M2014 | M2014B |
| M22x1,5 | 10-14 | 28 | 9 | 27 | M2214 | M2214B |
| M24x1,5 | 10-14 | 28 | 11 | 27 | M2414 | M2414B |
| M25x1,5 | 13-18 | 31 | 11 | 33 | M2518 | M2518B |
| M25x1,5 | 9-16 | 31 | 11 | 33 | M2516 | M2516B |
| M25x1,5 | 18-25 | 39 | 11 | 42 | M2525 | M2525B |
| M30x1,5 | 13-18 | 31 | 12 | 33 | M3018 | M3018B |
| M32x1,5 | 18-25 | 37 | 11 | 42 | M3225 | M3225B |
| M32x1,5 | 13-20 | 37 | 11 | 42 | M3220 | M3220B |
| M40x1,5 | 22-32 | 48 | 13 | 53 | M4032 | M4032B |
| M40x1,5 | 20-26 | 48 | 13 | 53 | M4026 | M4026B |
| M40x1,5 | 23-33,5 | 48 | 13 | 53 | M4033 | M4033B |
| M50x1,5 | 32-38 | 49 | 13 | 60 | M5038 | M5038B |
| M50x1,5 | 25-31 | 49 | 13 | 60 | M5031 | M5031B |
| M63x1,5 | 37-44 | 49 | 14 | 65/68 | M6344 | M6344B |
| M63x1,5 | 29-35 | 49 | 14 | 65/68 | M6335 | M6335B |
| M63x1,5 | 25-30,5 | 49 | 14 | 65/68 | M6330 | M6330B |
| M63x1,5 | 30,5-40 | 49 | 14 | 65/68 | M6340 | M6340B |
| M75x2 | 48-56 | 69 | 25 | 82 | M7556 | M7556B |
| M75x2 | 38-56 | 69 | 25 | 82 | M7547-T | M7547B-T |

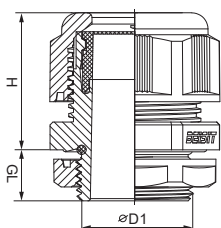

Пластиковый кабельный ввод тип М удлиненный M-Length Nylon Cable Glands



Материал: PA (NYLON), UL 94 V-2
Уплотнение: NBR, (EPDM, TPV, силикон)
Кольцо: EPDM
Температура: -40 C to 100 C
Цвет: Серый(RAL7035), Черный(RAL9005), другие цвета по запросу
Под заказ: V0, or F1 материал.

Material: PA (NYLON), UL 94 V-2
Hermetic seal: NBR, (EPDM Upon Request)
O-Ring: EPDM
Temperature: -40 C to 100 C
Color: Grey(RAL7035), Black(RAL9005), other colors customized.



| Thread ØD1 | ØK mm | H mm | Length GL mm | | Seal mm | Beisit No. | |
|---------------|----------|---------|--------------------|-------|------------|------------|-------|
| | | | grey | black | | grey | black |
| M12x1,5 | 3-6,5 | 21 | 15 | 15 | M1207L | M1207BL | |
| M12x1,5 | 2-5 | 21 | 15 | 15 | M1205L | M1205BL | |
| M16x1,5 | 4-8 | 22 | 15 | 19 | M1608L | M1608BL | |
| M16x1,5 | 2-6 | 22 | 15 | 19 | M1606L | M1606BL | |
| M16x1,5 | 5-10 | 25 | 15 | 22 | M1610L | M1610BL | |
| M20x1,5 | 6-12 | 27 | 15 | 24 | M2012L | M2012BL | |
| M20x1,5 | 5-9 | 27 | 15 | 24 | M2009L | M2009BL | |
| M20x1,5 | 10-14 | 28 | 15 | 27 | M2014L | M2014BL | |
| M25x1,5 | 13-18 | 31 | 15 | 33 | M2518L | M2518BL | |
| M25x1,5 | 9-16 | 31 | 15 | 33 | M2516L | M2516BL | |
| M32x1,5 | 18-25 | 39 | 15 | 42 | M3225L | M3225BL | |
| M32x1,5 | 13-20 | 39 | 15 | 42 | M3220L | M3220BL | |
| M40x1,5 | 22-32 | 48 | 18 | 53 | M4032L | M4032BL | |
| M40x1,5 | 20-26 | 48 | 18 | 53 | M4026L | M4026BL | |
| M50x1,5 | 32-38 | 49 | 18 | 60 | M5038L | M5038BL | |
| M50x1,5 | 25-31 | 49 | 18 | 60 | M5031L | M5031BL | |
| M63x1,5 | 37-44 | 49 | 18 | 65/68 | M6344L | M6344BL | |
| M63x1,5 | 29-35 | 49 | 18 | 65/68 | M6335L | M6335BL | |
| M63x1,5 | 25-30,5 | 49 | 18 | 65/68 | M6330L | M6330BL | |
| M63x1,5 | 30,5-40 | 49 | 18 | 65/68 | M6340L | M6340BL | |

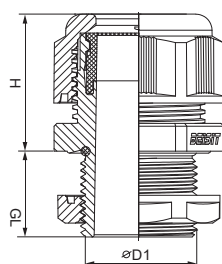

Металлический кабельный ввод тип М M Type Metal Cable Glands



Материал: Никелированная латунь
Зажим: PA (NYLON), UL 94 V-2
Уплотнение: NBR, (EPDM, TPV, силикон)
Кольцо: EPDM
Температура: -40 C to 100 C

Material: Nickel-plated brass
Fixture pack: PA (NYLON), UL 94 V-2
Hermetic seal: NBR, (EPDM Upon Request)
O-Ring: EPDM
Temperature: -40 C to 100 C



| Thread ØD1 | ØK mm | H mm | GL mm | Seal mm | Claw mm | Seal mm | Sealing Nut mm | Beisit No. |
|---------------|----------|---------|----------|------------|------------|------------|-------------------|------------|
| | | | | | | | | |
| M12x1,5 | 2-5 | 19 | 6,5 | 14 | | | | M1205BR |
| M16x1,5 | 4-8 | 21 | 6 | 17/19 | | | | M1608BR |
| M16x1,5 | 2-6 | 21 | 6 | 17/19 | | | | M1606BR |
| M16x1,5 | 5-10 | 22 | 6 | 20 | | | | M1610BR |
| M20x1,5 | 6-12 | 23 | 6 | 22 | | | | M2012BR |
| M20x1,5 | 5-9 | 23 | 6 | 22 | | | | M2009BR |
| M20x1,5 | 10-14 | 24 | 6 | 24 | | | | M2014BR |
| M25x1,5 | 13-18 | 25 | 7 | 30 | | | | M2518BR |
| M25x1,5 | 9-16 | 25 | 7 | 30 | | | | M2516BR |
| M32x1,5 | 18-25 | 31 | 8 | 40 | | | | M3225BR |
| M32x1,5 | 13-20 | 31 | 8 | 40 | | | | M3220BR |
| M40x1,5 | 22-32 | 37 | 8 | 50 | | | | M4032BR |
| M40x1,5 | 20-26 | 37 | 8 | 50 | | | | M4026BR |
| M50x1,5 | 32-38 | 37 | 9 | 57 | | | | M5038BR |
| M50x1,5 | 25-31 | 37 | 9 | 57 | | | | M5031BR |
| M63x1,5 | 37-44 | 38 | 10 | 64/68 | | | | M6344BR |
| M63x1,5 | 29-35 | 38 | 10 | 64/68 | | | | M6335BR |
| M75x1,5 | 42-52 | 42 | 10 | 78 | | | | M7552BR |
| M80x2,0 | 50-62 | 42 | 15 | 88 | | | | M8062BR |
| M90x2,0 | 60-70 | 42 | 15 | 100 | | | | M9070BR |
| M100x2,0 | 70-80 | 42 | 17 | 110 | | | | M10080BR |
| *M27x1,5 | 13-18 | 25 | 7 | 30 | | | | M2718BR |
| *M27x1,5 | 9-16 | 25 | | | | | | M2716BR |

*Non-Standard Thread / Не стандарт

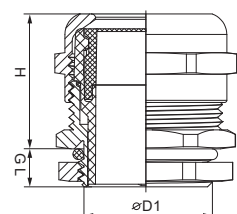

Металлический кабельный ввод тип М удлиненный
M-Length Metal Cable Glands



Материал: Никелированная латунь
Зажим: PA (NYLON), UL 94 V-2
Уплотнение: NBR, (EPDM, TPV, силикон)
Кольцо: EPDM
Температура: -40 °C to 100 °C

Material: Nickel-plated brass
Fixture pack: PA (NYLON), UL 94 V-2
Hermetic seal: NBR, (EPDM Upon Request)
O-Ring: EPDM
Temperature: -40°C to 100°C

Металлический кабельный ввод тип М усиленный
M Metal Cable Glands-Reinforced Type



Материал: Никелированная латунь
Зажим: PA (NYLON), UL 94 V-2
Уплотнение: NBR, (EPDM, TPV, силикон)
Кольцо: EPDM
Температура: -40 °C to 100 °C

Material: Nickel-plated brass
Fixture pack: PA (NYLON), UL 94 V-2
Hermetic seal: NBR, (EPDM Upon Request)
O-Ring: EPDM
Temperature: -40°C to 100°C

Металлический кабельный ввод тип М-L усиленный
M-Length Metal Cable Glands-Reinforced Type



Материал: Никелированная латунь
Зажим: PA (NYLON), UL 94 V-2
Уплотнение: NBR, (EPDM, TPV, силикон)
Кольцо: EPDM
Температура: -40 °C to 100 °C

Material: Nickel-plated brass
Fixture pack: PA (NYLON), UL 94 V-2
Hermetic seal: NBR, (EPDM Upon Request)
O-Ring: EPDM
Temperature: -40°C to 100°C



| Thread ØD1 | Øk mm | H mm | Length GL mm | Seal mm | Beisit No. |
|---------------|----------|---------|--------------------|------------|------------|
| M12x1,5 | 3-6,5 | 19 | 10 | 14 | M1207BRL |
| M12x1,5 | 2-5 | 19 | 10 | 14 | M1205BRL |
| M16x1,5 | 4-8 | 21 | 10 | 17/19 | M1608BRL |
| M16x1,5 | 2-6 | 21 | 10 | 17/19 | M1606BRL |
| M16x1,5 | 5-10 | 22 | 10 | 20 | M1610BRL |
| M20x1,5 | 6-12 | 23 | 10 | 22 | M2012BRL |
| M20x1,5 | 5-9 | 23 | 10 | 22 | M2009BRL |
| M20x1,5 | 10-14 | 24 | 10 | 24 | M2014BRL |
| M25x1,5 | 13-18 | 25 | 12 | 30 | M2518BRL |
| M25x1,5 | 9-16 | 25 | 12 | 30 | M2516BRL |
| M32x1,5 | 18-25 | 31 | 12 | 40 | M3225BRL |
| M32x1,5 | 13-20 | 31 | 12 | 40 | M3220BRL |
| M40x1,5 | 22-32 | 37 | 15 | 50 | M4032BRL |
| M40x1,5 | 20-26 | 37 | 15 | 50 | M4026BRL |
| M50x1,5 | 32-38 | 37 | 15 | 57 | M5038BRL |
| M50x1,5 | 25-31 | 37 | 15 | 57 | M5031BRL |
| M63x1,5 | 37-44 | 38 | 15 | 64/68 | M6344BRL |
| M63x1,5 | 29-35 | 38 | 15 | 64/68 | M6335BRL |
| *M18x1,5 | 5-10 | 22 | 10 | 20 | M1810BRL |
| *M18x1,5 | 3-7 | 22 | 10 | 20 | M1807BRL |
| *M22x1,5 | 10-14 | 24 | 10 | 24 | M2214BRL |
| *M22x1,5 | 7-12 | 24 | 10 | 24 | M2212BRL |
| *M24x1,5 | 13-18 | 25 | 12 | 30 | M2418BRL |
| *M24x1,5 | 9-16 | 25 | 12 | 30 | M2416BRL |
| *M27x1,5 | 13-18 | 25 | 12 | 30 | M2718BRL |
| *M27x1,5 | 9-16 | 25 | 12 | 30 | M2716BRL |

*Non-Standard Thread/Не стандарт

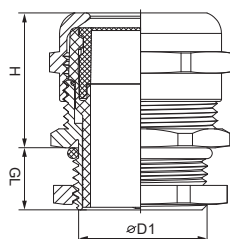

| Thread ØD1 | Øk mm | H mm | GL mm | Seal mm | Beisit No. |
|---------------|----------|---------|----------|------------|------------|
| M12x1,5 | 3-6.5 | 19 | 6.5 | 14 | M1207BR-R |
| M12x1,5 | 2-5 | 19 | 6.5 | 14 | M1205BR-R |
| M16x1,5 | 4-8 | 21 | 6 | 17/19 | M1608BR-R |
| M16x1,5 | 2-6 | 21 | 6 | 17/19 | M1606BR-R |
| M16x1,5 | 5-10 | 22 | 6 | 20 | M1610BR-R |
| M20x1,5 | 6-12 | 23 | 6 | 22 | M2012BR-R |
| M20x1,5 | 5-9 | 23 | 6 | 22 | M2009BR-R |
| M20x1,5 | 10-14 | 24 | 6 | 24 | M2014BR-R |
| M25x1,5 | 13-18 | 25 | 7 | 30 | M2518BR-R |
| M25x1,5 | 9-16 | 25 | 7 | 30 | M2516BR-R |
| M32x1,5 | 18-25 | 31 | 8 | 40 | M3225BR-R |
| M32x1,5 | 13-20 | 31 | 8 | 40 | M3220BR-R |
| M40x1,5 | 22-32 | 37 | 8 | 50 | M4032BR-R |
| M40x1,5 | 20-26 | 37 | 8 | 50 | M4026BR-R |
| M50x1,5 | 32-38 | 37 | 9 | 57 | M5038BR-R |
| M50x1,5 | 25-31 | 37 | 9 | 57 | M5031BR-R |
| M63x1,5 | 37-44 | 38 | 10 | 64/68 | M6344BR-R |
| M63x1,5 | 29-35 | 38 | 10 | 64/68 | M6335BR-R |
| *M18x1,5 | 5-10 | 22 | 6 | 20 | M1810BR-R |
| *M18x1,5 | 3-7 | 22 | 6 | 20 | M1807BR-R |
| *M22x1,5 | 10-14 | 24 | 6 | 24 | M2214BR-R |
| *M22x1,5 | 7-12 | 24 | 6 | 24 | M2212BR-R |
| *M24x1,5 | 13-18 | 25 | 7 | 30 | M2418BR-R |
| *M24x1,5 | 9-16 | 25 | 7 | 30 | M2416BR-R |
| *M27x1,5 | 13-18 | 25 | 7 | 30 | M2718BR-R |
| *M27x1,5 | 9-16 | 25 | 7 | 30 | M2716BR-R |

*Non-Standard Thread/Не стандарт

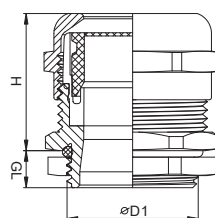

| Thread ØD1 | Øk mm | H mm | GL mm | Seal mm | Beisit No. |
|---------------|----------|---------|----------|------------|------------|
| M12x1,5 | 3-6.5 | 19 | 10 | 14 | M1207BRL-R |
| M12x1,5 | 2-5 | 19 | 10 | 14 | M1205BRL-R |
| M16x1,5 | 4-8 | 21 | 10 | 17/19 | M1608BRL-R |
| M16x1,5 | 2-6 | 21 | 10 | 17/19 | M1606BRL-R |
| M16x1,5 | 5-10 | 22 | 10 | 20 | M1610BRL-R |
| M20x1,5 | 6-12 | 23 | 10 | 22 | M2012BRL-R |
| M20x1,5 | 5-9 | 23 | 10 | 22 | M2009BRL-R |
| M20x1,5 | 10-14 | 24 | 10 | 24 | M2014BRL-R |
| M25x1,5 | 13-18 | 25 | 12 | 30 | M2518BRL-R |
| M25x1,5 | 9-16 | 25 | 12 | 30 | M2516BRL-R |
| M32x1,5 | 18-25 | 31 | 12 | 40 | M3225BRL-R |
| M32x1,5 | 13-20 | 31 | 12 | 40 | M3220BRL-R |
| M40x1,5 | 22-32 | 37 | 15 | 50 | M4032BRL-R |
| M40x1,5 | 20-26 | 37 | 15 | 50 | M4026BRL-R |
| M50x1,5 | 32-38 | 37 | 15 | 57 | M5038BRL-R |
| M50x1,5 | 25-31 | 37 | 15 | 57 | M5031BRL-R |
| M63x1,5 | 37-44 | 38 | 15 | 64/68 | M6344BRL-R |
| M63x1,5 | 29-35 | 38 | 15 | 64/68 | M6335BRL-R |
| *M18x1,5 | 5-10 | 22 | 10 | 20 | M1810BRL-R |
| *M18x1,5 | 3-7 | 22 | 10 | 20 | M1807BRL-R |
| *M22x1,5 | 10-14 | 24 | 10 | 24 | M2214BRL-R |
| *M22x1,5 | 7-12 | 24 | 10 | 24 | M2212BRL-R |
| *M24x1,5 | 13-18 | 25 | 12 | 30 | M2418BRL-R |
| *M24x1,5 | 9-16 | 25 | 12 | 30 | M2416BRL-R |
| *M27x1,5 | 13-18 | 25 | 12 | 30 | M2718BRL-R |
| *M27x1,5 | 9-16 | 25 | 12 | 30 | M2716BRL-R |

*Non-Standard Thread/Не стандарт

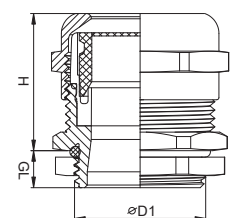

Пластиковый кабельный ввод тип PG
PG Type Nylon Cable Glands



Материал: PA (NYLON), UL 94 V-2
Уплотнение: NBR, (EPDM, TPV, силикон)
Кольцо: EPDM
Температура: -40°C to 100°C
Цвет: Серый(RAL7035), Черный(RAL9005), другие цвета по запросу
Под заказ: V0, or F1 материал.

Material: PA (NYLON), UL 94 V-2
Hermetic seal: NBR, (EPDM Upon Request)
O-Ring: EPDM
Temperature: -40°C to 100°C
Color: Grey(RAL7035), Black(RAL9005), other colors customized.

Material options: V0, or F1 can be offered upon request.



| Thread ØD1 | Øk mm | H mm | GL mm | mm | Beisit No. grey | Beisit No. black |
|---------------|----------|---------|----------|--------|--------------------|---------------------|
|---------------|----------|---------|----------|--------|--------------------|---------------------|

| | | | | | | |
|---------|---------|----|----|----|----------|-----------|
| PG 7 | 3-6,5 | 21 | 8 | 15 | P0707 | P0707B |
| PG 7 | 2-5 | 21 | 8 | 15 | P0705 | P0705B |
| PG 9 | 4-8 | 22 | 8 | 19 | P0908 | P0908B |
| PG 9 | 2-6 | 22 | 8 | 19 | P0906 | P0906B |
| PG 11 | 5-10 | 25 | 8 | 22 | P1110 | P1110B |
| PG 11 | 3-7 | 25 | 8 | 22 | P1107 | P1107B |
| PG 13,5 | 6-12 | 27 | 9 | 24 | P13512 | P13512B |
| PG 13,5 | 5-9 | 27 | 9 | 24 | P13509 | P13509B |
| PG 16 | 10-14 | 28 | 10 | 27 | P1614 | P1614B |
| PG 16 | 7-12 | 28 | 10 | 27 | P1612 | P1612B |
| PG 21 | 13-18 | 31 | 11 | 33 | P2118 | P2118B |
| PG 21 | 9-16 | 31 | 11 | 33 | P2116 | P2116B |
| PG 29 | 18-25 | 37 | 11 | 42 | P2925 | P2925B |
| PG 29 | 13-20 | 37 | 11 | 42 | P2920 | P2920B |
| PG 36 | 22-32 | 48 | 13 | 53 | P3632 | P3632B |
| PG 36 | 20-26 | 48 | 13 | 53 | P3626 | P3626B |
| PG 42 | 32-38 | 49 | 13 | 60 | P4238 | P4238B |
| PG 42 | 25-31 | 49 | 13 | 60 | P4231 | P4231B |
| PG 48 | 37-44 | 49 | 14 | 65 | P4844 | P4844B |
| PG 48 | 29-35 | 49 | 14 | 65 | P4835 | P4835B |
| PG 48 | 25-30,5 | 49 | 14 | 65 | P4830 | P4830B |
| PG 48 | 30,5-40 | 49 | 14 | 65 | P4840 | P4840B |
| PG 48 | 40-50 | 52 | 14 | 70 | P4850 | P4850B |
| PG 48 | 30-50 | 52 | 14 | 70 | P4840-T | P4840B-T |
| *PG 19 | 12-15 | 33 | 11 | 27 | P1915-HW | P1915B-HW |
| *PG 19 | 12-15 | 30 | 12 | 27 | P1915-DH | P1915B-DH |

*Non-Standard Thread/Не стандарт

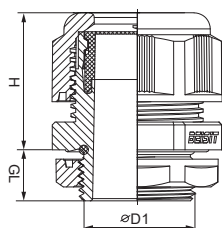

Пластиковый кабельный ввод тип PG удлиненный
PG-Length Nylon Cable Glands



Материал: PA (NYLON), UL 94 V-2
Уплотнение: NBR, (EPDM, TPV, силикон)
Кольцо: EPDM
Температура: -40°C to 100°C
Цвет: Серый(RAL7035), Черный(RAL9005), другие цвета по запросу
Под заказ: V0, or F1 материал.

Material: PA (NYLON), UL 94 V-2
Hermetic seal: NBR, (EPDM Upon Request)
O-Ring: EPDM
Temperature: -40°C to 100°C
Color: Grey(RAL7035), Black(RAL9005), other colors customized.

Material options: V0, or F1 can be offered upon request.



| Thread ØD1 | Øk mm | H mm | Length GL mm | mm | Beisit No. grey | Beisit No. black |
|---------------|----------|---------|--------------------|--------|--------------------|---------------------|
|---------------|----------|---------|--------------------|--------|--------------------|---------------------|

| | | | | | | |
|---------|---------|----|----|----|---------|----------|
| PG 7 | 3-6,5 | 21 | 15 | 15 | P0707L | P0707BL |
| PG 7 | 2-5 | 21 | 15 | 15 | P0705L | P0705BL |
| PG 9 | 4-8 | 22 | 15 | 19 | P0908L | P0908BL |
| PG 9 | 2-6 | 22 | 15 | 19 | P0906L | P0906BL |
| PG 11 | 5-10 | 25 | 15 | 22 | P1110L | P1110BL |
| PG 11 | 3-7 | 25 | 15 | 22 | P1107L | P1107BL |
| PG 13,5 | 6-12 | 27 | 15 | 24 | P13512L | P13512BL |
| PG 13,5 | 5-9 | 27 | 15 | 24 | P13509L | P13509BL |
| PG 16 | 10-14 | 28 | 15 | 27 | P1614L | P1614BL |
| PG 16 | 7-12 | 28 | 15 | 27 | P1612L | P1612BL |
| PG 21 | 13-18 | 31 | 15 | 33 | P2118L | P2118BL |
| PG 21 | 9-16 | 31 | 15 | 33 | P2116L | P2116BL |
| PG 29 | 18-25 | 37 | 15 | 42 | P2925L | P2925BL |
| PG 29 | 13-20 | 37 | 15 | 42 | P2920L | P2920BL |
| PG 36 | 22-32 | 48 | 18 | 53 | P3632L | P3632BL |
| PG 36 | 20-26 | 48 | 18 | 53 | P3626L | P3626BL |
| PG 42 | 32-38 | 49 | 18 | 60 | P4238L | P4238BL |
| PG 42 | 25-31 | 49 | 18 | 60 | P4231L | P4231BL |
| PG 48 | 37-44 | 49 | 18 | 65 | P4844L | P4844BL |
| PG 48 | 29-35 | 49 | 18 | 65 | P4835L | P4835BL |
| PG 48 | 25-30,5 | 49 | 18 | 65 | P4830L | P4830BL |
| PG 48 | 30,5-40 | 49 | 18 | 65 | P4840L | P4840BL |

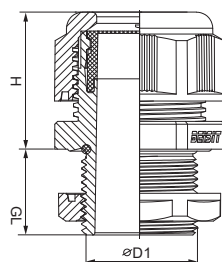

Металлический кабельный ввод тип PG
PG Type Metal Cable Glands



Материал: Никелированная латунь
Зажим: PA (NYLON), UL 94 V-2
Уплотнение: NBR, (EPDM, TPV, силикон)
Кольцо: EPDM
Температура: -40°C to 100°C

Material: Nickel-plated brass
Fixture pack: PA (NYLON), UL 94 V-2
Hermetic seal: NBR, (EPDM Upon Request)
O-Ring: EPDM
Temperature: -40°C to 100°C



| Thread ØD1 | Øk mm | H mm | GL mm | mm | Beisit No. |
|---------------|----------|---------|----------|--------|------------|
|---------------|----------|---------|----------|--------|------------|

| | | | | | |
|---------|-------|----|-----|----|----------|
| PG 7 | 3-6,5 | 19 | 5 | 14 | P0707BR |
| PG 7 | 2-5 | 19 | 5 | 14 | P0705BR |
| PG 9 | 4-8 | 21 | 6 | 17 | P0908BR |
| PG 9 | 2-6 | 21 | 6 | 17 | P0906BR |
| PG 11 | 5-10 | 22 | 6 | 20 | P1110BR |
| PG 11 | 3-7 | 22 | 6 | 20 | P1107BR |
| PG 13,5 | 6-12 | 23 | 6,5 | 22 | P13512BR |
| PG 13,5 | 5-9 | 23 | 6,5 | 22 | P13509BR |
| PG 16 | 10-14 | 24 | 6,5 | 24 | P1614BR |
| PG 16 | 7-12 | 24 | 6,5 | 24 | P1612BR |
| PG 21 | 13-18 | 25 | 7 | 30 | P2118BR |
| PG 21 | 9-16 | 25 | 7 | 30 | P2116BR |
| PG 29 | 18-25 | 31 | 8 | 40 | P2925BR |
| PG 29 | 13-20 | 31 | 8 | 40 | P2920BR |
| PG 36 | 22-32 | 37 | 8 | 50 | P3632BR |
| PG 36 | 20-26 | 37 | 8 | 50 | P3626BR |
| PG 42 | 32-38 | 37 | 9 | 57 | P4238BR |
| PG 42 | 25-31 | 37 | 9 | 57 | P4231BR |
| PG 48 | 37-44 | 38 | 10 | 64 | P4844BR |
| PG 48 | 29-35 | 38 | 10 | 64 | P4835BR |

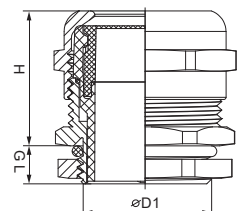

Металлический кабельный ввод тип PG удлиненный
PG-Length Metal Cable Glands



Материал: Никелированная латунь
Зажим: PA (NYLON), UL 94 V-2
Уплотнение: NBR, (EPDM, TPV, силикон)
Кольцо: EPDM
Температура: -40 °C to 100 °C

Material: Nickel-plated brass
Fixture pack: PA (NYLON), UL 94 V-2
Hermetic seal: NBR, (EPDM Upon Request)
O-Ring: EPDM
Temperature: -40°C to 100°C

Lock Nut O-Ring Body O-Ring Claw Seal Sealing Nut
Гайка Кольцо Корпус Кольцо Зажим Уплотнение Кольцо



| Thread Ø D1 | ∅k mm | H mm | Length GL mm | mm | Beisit No. |
|----------------|----------|---------|--------------------|----|------------|
| PG 7 | 3-6,5 | 19 | 10 | 14 | P0707BRL |
| PG 7 | 2-5 | 19 | 10 | 14 | P0705BRL |
| PG 9 | 4-8 | 21 | 10 | 17 | P0908BRL |
| PG 9 | 2-6 | 21 | 10 | 17 | P0906BRL |
| PG 11 | 5-10 | 22 | 10 | 20 | P1110BRL |
| PG 11 | 3-7 | 22 | 10 | 20 | P1107BRL |
| PG 13,5 | 6-12 | 23 | 10 | 22 | P13512BRL |
| PG 13,5 | 5-9 | 23 | 10 | 22 | P13509BRL |
| PG 16 | 10-14 | 24 | 10 | 24 | P1614BRL |
| PG 16 | 7-12 | 24 | 10 | 24 | P1612BRL |
| PG 21 | 13-18 | 25 | 12 | 30 | P2118BRL |
| PG 21 | 9-16 | 25 | 12 | 30 | P2116BRL |
| PG 29 | 18-25 | 31 | 12 | 40 | P2925BRL |
| PG 29 | 13-20 | 31 | 12 | 40 | P2920BRL |
| PG 36 | 22-32 | 37 | 15 | 50 | P3632BRL |
| PG 36 | 20-26 | 37 | 15 | 50 | P3626BRL |
| PG 42 | 32-38 | 37 | 15 | 57 | P4238BRL |
| PG 42 | 25-31 | 37 | 15 | 57 | P4231BRL |
| PG 48 | 37-44 | 38 | 15 | 64 | P4844BRL |
| PG 48 | 29-35 | 38 | 15 | 64 | P4835BRL |

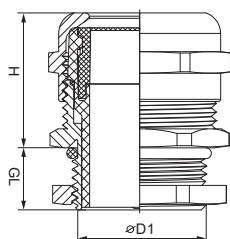

Металлический кабельный ввод тип PG усиленный
PG Metal Cable Glands-Reinforced Type

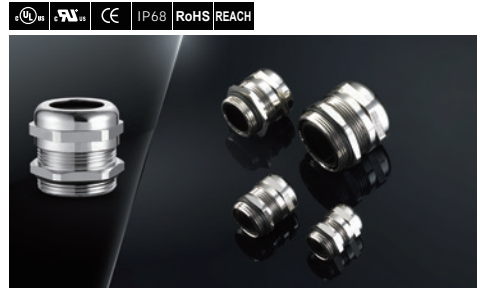

Материал: Никелированная латунь
Зажим: PA (NYLON), UL 94 V-2
Уплотнение: NBR, (EPDM, TPV, силикон)
Кольцо: EPDM
Температура: -40 °C to 100 °C

Material: Nickel-plated brass
Fixture pack: PA (NYLON), UL 94 V-2
Hermetic seal: NBR, (EPDM Upon Request)
O-Ring: EPDM
Temperature: -40°C to 100°C

Lock O-Ring Body O-Ring Claw Seal Sealing Nut
Гайка Кольцо Корпус Кольцо Зажим Уплотнение Гайка



| Thread Ø D1 | ∅k mm | H mm | GL mm | mm | Beisit No. |
|----------------|----------|---------|----------|----|------------|
| PG7 | 3-6.5 | 19 | 5 | 14 | P0707BR-R |
| PG7 | 2-5 | 19 | 5 | 14 | P0705BR-R |
| PG9 | 4-8 | 21 | 6 | 17 | P0908BR-R |
| PG9 | 2-6 | 21 | 6 | 17 | P0906BR-R |
| PG11 | 5-10 | 22 | 6 | 20 | P1110BR-R |
| PG11 | 3-7 | 22 | 6 | 20 | P1107BR-R |
| PG13.5 | 6-12 | 23 | 6.5 | 22 | P13512BR-R |
| PG13.5 | 5-9 | 23 | 6.5 | 22 | P13509BR-R |
| PG16 | 10-14 | 24 | 6.5 | 24 | P1614BR-R |
| PG16 | 7-12 | 24 | 6.5 | 24 | P1612BR-R |
| PG21 | 13-18 | 25 | 7 | 30 | P2118BR-R |
| PG21 | 9-16 | 25 | 7 | 30 | P2116BR-R |
| PG29 | 18-25 | 31 | 8 | 40 | P2925BR-R |
| PG29 | 13-20 | 31 | 8 | 40 | P2920BR-R |
| PG36 | 22-32 | 37 | 8 | 50 | P3632BR-R |
| PG36 | 20-26 | 37 | 8 | 50 | P3626BR-R |
| PG42 | 32-38 | 37 | 9 | 57 | P4238BR-R |
| PG42 | 25-31 | 37 | 9 | 57 | P4231BR-R |
| PG48 | 37-44 | 38 | 10 | 64 | P4844BR-R |
| PG48 | 29-35 | 38 | 10 | 64 | P4835BR-R |

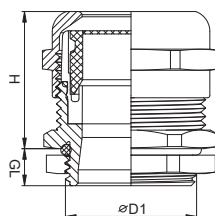

Металлический кабельный ввод тип PG-L усиленный
PG-Length Metal Cable Glands-Reinforced Type



Материал: Никелированная латунь
Зажим: PA (NYLON), UL 94 V-2
Уплотнение: NBR, (EPDM, TPV, силикон)
Кольцо: EPDM
Температура: -40 °C to 100 °C

Material: Nickel-plated brass
Fixture pack: PA (NYLON), UL 94 V-2
Hermetic seal: NBR, (EPDM Upon Request)
O-Ring: EPDM
Temperature: -40°C to 100°C

Lock Nut O-Ring Body O-Ring Claw Seal Sealing Nut
Гайка Кольцо Корпус Кольцо Зажим Уплотнение Гайка



| Thread Ø D1 | ∅k mm | H mm | Length GL mm | mm | Beisit No. |
|----------------|----------|---------|--------------------|----|-------------|
| PG7 | 3-6.5 | 19 | 10 | 14 | P0707BRL-R |
| PG7 | 2-5 | 19 | 10 | 14 | P0705BRL-R |
| PG9 | 4-8 | 21 | 10 | 17 | P0908BRL-R |
| PG9 | 2-6 | 21 | 10 | 17 | P0906BRL-R |
| PG11 | 5-10 | 22 | 10 | 20 | P1110BRL-R |
| PG11 | 3-7 | 22 | 10 | 20 | P1107BRL-R |
| PG13.5 | 6-12 | 23 | 10 | 22 | P13512BRL-R |
| PG13.5 | 5-9 | 23 | 10 | 22 | P13509BRL-R |
| PG16 | 10-14 | 24 | 10 | 24 | P1614BRL-R |
| PG16 | 7-12 | 24 | 10 | 24 | P1612BRL-R |
| PG21 | 13-18 | 25 | 12 | 30 | P2118BRL-R |
| PG21 | 9-16 | 25 | 12 | 30 | P2116BRL-R |
| PG29 | 18-25 | 31 | 12 | 40 | P2925BRL-R |
| PG29 | 13-20 | 31 | 12 | 40 | P2920BRL-R |
| PG36 | 22-32 | 37 | 15 | 50 | P3632BRL-R |
| PG36 | 20-26 | 37 | 15 | 50 | P3626BRL-R |
| PG42 | 32-38 | 37 | 15 | 57 | P4238BRL-R |
| PG42 | 25-31 | 37 | 15 | 57 | P4231BRL-R |
| PG48 | 37-44 | 38 | 15 | 64 | P4844BRL-R |
| PG48 | 29-35 | 38 | 15 | 64 | P4835BRL-R |

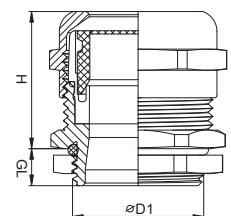

Пластиковый кабельный ввод тип NPT
NPT Type Nylon Cable Glands



Материал: PA (NYLON), UL 94 V-2
Уплотнение: NBR, (EPDM, TPV, силикон)
Кольцо: EPDM
Температура: -40 °C to 100 °C
Цвет: Серый(RAL7035), Черный(RAL9005), другие цвета по запросу
Под заказ: V0, or F1 материал.

Material: PA (NYLON), UL 94 V-2
Hermetic seal: NBR, (EPDM Upon Request)
O-Ring: EPDM
Temperature: -40 °C to 100 °C
Color: Grey(RAL7035), Black(RAL9005), other colors customized.

Material options: V0, or F1 can be offered upon request.



| Thread ØD1 | mm | H mm | GL mm | mm | Beisit No. grey | Beisit No. black |
|---------------|---------|---------|----------|-------|--------------------|---------------------|
| 1/4" NPT | 3-6.5 | 21 | 8 | 15 | N1407 | N1407B |
| 1/4" NPT | 2-5 | 21 | 8 | 15 | N1405 | N1405B |
| 3/8" NPT | 4-8 | 22 | 15 | 22 | N3808 | N3808B |
| 3/8" NPT | 2-6 | 22 | 15 | 22 | N3806 | N3806B |
| 1/2" NPT | 6-12 | 27 | 13 | 24 | N12612 | N12612B |
| 1/2" NPT | 5-9 | 27 | 13 | 24 | N1209 | N1209B |
| 1/2" NPT/E | 10-14 | 28 | 13 | 27 | N1214 | N1214B |
| 1/2" NPT/E | 7-12 | 28 | 13 | 27 | N12712 | N12712B |
| 3/4" NPT | 13-18 | 31 | 14 | 33 | N3418 | N3418B |
| 3/4" NPT | 9-16 | 31 | 14 | 33 | N3416 | N3416B |
| 1" NPT | 18-25 | 37 | 19 | 42 | N10025 | N10025B |
| 1" NPT | 13-20 | 37 | 19 | 42 | N10020 | N10020B |
| 1 1/4" NPT | 18-25 | 39 | 16 | 42/46 | N11425 | N11425B |
| 1 1/4" NPT | 13-20 | 39 | 16 | 42/46 | N11420 | N11420B |
| 1 1/2" NPT | 22-32 | 48 | 20 | 53 | N11232 | N11232B |
| 1 1/2" NPT | 20-26 | 48 | 20 | 53 | N11226 | N11226B |
| 2" NPT | 37-44 | 49 | 20 | 65 | N20044 | N20044B |
| 2" NPT | 29-35 | 49 | 20 | 65 | N20035 | N20035B |
| 2" NPT | 25-30.5 | 49 | 20 | 65 | N20030 | N20030B |
| 2" NPT | 30.5-40 | 49 | 20 | 65 | N20040 | N20040B |

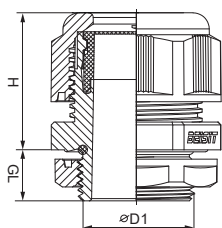

Металлический кабельный ввод тип NPT
NPT Type Metal Cable Glands



Материал: Никелированная латунь
Зажим: PA (NYLON), UL 94 V-2
Уплотнение: NBR, (EPDM, TPV, силикон)
Кольцо: EPDM
Температура: -40 °C to 100 °C
Под заказ: с другой резьбой: G(BSP), PF, PS, NPT

Material: Nickel-plated brass
Fixture pack: PA (NYLON), UL 94 V-2
Hermetic seal: NBR, (EPDM Upon Request)
O-Ring: EPDM
Working temperature: -40 °C to 100 °C
Note: Other screw thread type G(BSP), PF, PS, NPT can be supplied as request



| Thread ØD1 | mm | H mm | GL mm | mm | Beisit No. |
|---------------|-------|---------|----------|-------|------------|
| 1/4" NPT | 3-6.5 | 19 | 13 | 14 | N1407BR |
| 1/4" NPT | 2-5 | 19 | 13 | 14 | N1405BR |
| 3/8" NPT | 4-8 | 21 | 15 | 17/19 | N3808BR |
| 3/8" NPT | 2-6 | 21 | 15 | 17/19 | N3806BR |
| 1/2" NPT | 6-12 | 23 | 13 | 22 | N1212BR |
| 1/2" NPT | 5-9 | 23 | 13 | 22 | N1209BR |
| 1/2" NPT/E | 10-14 | 24 | 13 | 24 | N1214BR |
| 1/2" NPT/E | 7-12 | 24 | 13 | 24 | N12712BR |
| 3/4" NPT | 13-18 | 25 | 13 | 30 | N3418BR |
| 3/4" NPT | 9-16 | 25 | 13 | 30 | N3416BR |
| 1" NPT | 18-25 | 31 | 15 | 40 | N10025BR |
| 1" NPT | 13-20 | 31 | 15 | 40 | N10020BR |
| 1 1/4" NPT | 18-25 | 31 | 17 | 44 | N11425BR |
| 1 1/4" NPT | 13-20 | 31 | 17 | 44 | N11420BR |
| 1 1/2" NPT | 22-32 | 37 | 20 | 50 | N11232BR |
| 1 1/2" NPT | 20-26 | 37 | 20 | 50 | N11226BR |
| 2" NPT | 37-44 | 38 | 21 | 64 | N20044BR |
| 2" NPT | 29-35 | 38 | 21 | 64 | N20035BR |

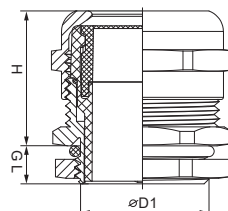

Металлический кабельный ввод тип NPT усиленный
NPT Metal Cable Glands-Reinforced Type



Материал: Никелированная латунь
Зажим: PA (NYLON), UL 94 V-2
Уплотнение: NBR, (EPDM, TPV, силикон)
Кольцо: EPDM
Температура: -40 °C to 100 °C

Material: Nickel-plated brass
Fixture pack: PA (NYLON), UL 94 V-2
Hermetic seal: NBR, (EPDM Upon Request)
O-Ring: EPDM
Temperature: -40 °C to 100 °C



| Thread ØD1 | mm | H mm | GL mm | mm | Beisit No. |
|---------------|-------|---------|----------|----|------------|
| 1/4" NPT | 3-6.5 | 19 | 13 | 14 | N1407BR-R |
| 1/4" NPT | 2-5 | 19 | 13 | 14 | N1405BR-R |
| 3/8" NPT | 4-8 | 21 | 15 | 20 | N3810BR-R |
| 3/8" NPT | 5-10 | 22 | 15 | 20 | N3810BR-R |
| 3/8" NPT | 3-7 | 22 | 15 | 20 | N3807BR-R |
| 1/2" NPT | 10-14 | 24 | 13 | 24 | N1214BR-R |
| 1/2" NPT | 7-12 | 24 | 13 | 24 | N1212BR-R |
| 3/4" NPT | 13-18 | 25 | 13 | 30 | N3418BR-R |
| 3/4" NPT | 9-16 | 25 | 13 | 30 | N3416BR-R |
| 1" NPT | 18-25 | 31 | 15 | 40 | N10025BR-R |
| 1" NPT | 13-20 | 31 | 15 | 40 | N10020BR-R |
| 1 1/4" NPT | 18-25 | 31 | 17 | 44 | N11425BR-R |
| 1 1/4" NPT | 13-20 | 31 | 17 | 44 | N11420BR-R |
| 1 1/2" NPT | 22-32 | 37 | 20 | 50 | N11232BR-R |
| 1 1/2" NPT | 20-26 | 37 | 20 | 50 | N11226BR-R |
| 2" NPT | 37-44 | 38 | 20 | 64 | N20044BR-R |
| 2" NPT | 29-35 | 38 | 20 | 64 | N20035BR-R |

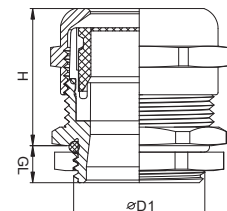

Пластиковый кабельный ввод тип G (PF)
G(PF) Type Nylon Cable Glands



Материал: PA (NYLON), UL 94 V-2
Уплотнение: NBR, (EPDM, TPV, силикон)
Кольцо: EPDM
Температура: -40 °C to 100 °C
Цвет: Серый(RAL7035), Черный(RAL9005), другие цвета по запросу
Под заказа: V0, or F1 материал.

Material: PA (NYLON), UL 94 V-2
Hermetic seal: NBR, (EPDM Upon Request)
O-Ring: EPDM
Temperature: -40°C to 100°C
Color: Grey(RAL7035), Black(RAL9005), other colors customized.
Material options: V0, or F1 can be offered upon request.



| Thread Ø D1 | mm | H mm | GL mm | mm | Beisit No. black | Beisit No. grey |
|----------------|---------|---------|----------|-------|---------------------|--------------------|
| G(PF)1/4" | 3-6,5 | 21 | 9 | 15 | G1407 | G1407B |
| G(PF)1/4" | 2-5 | 21 | 9 | 15 | G1405 | G1405B |
| G(PF)3/8" | 4-8 | 22 | 10 | 19/22 | G3808 | G3808B |
| G(PF)3/8" | 2-6 | 22 | 10 | 19/22 | G3806 | G3806B |
| G(PF)1/2" | 6-12 | 26 | 10 | 24 | G1212 | G1212B |
| G(PF)1/2" | 5-9 | 26 | 10 | 24 | G1209 | G1209B |
| G(PF)1/2" | 10-14 | 28 | 10 | 27 | G1214 | G1214B |
| G(PF)3/4" | 13-18 | 31 | 15 | 33 | G3418 | G3418B |
| G(PF)3/4" | 9-16 | 31 | 15 | 33 | G3416 | G3416B |
| G(PF)1" | 18-25 | 39 | 15 | 42 | G10025 | G10025B |
| G(PF)1" | 13-20 | 39 | 15 | 42 | G10020 | G10020B |
| G(PF)1 1/4" | 22-32 | 48 | 15 | 53 | G11432 | G11432B |
| G(PF)1 1/4" | 20-26 | 48 | 15 | 53 | G11426 | G11426B |
| G(PF)1 1/2" | 32-38 | 49 | 20 | 60 | G11238 | G11238B |
| G(PF)1 1/2" | 25-31 | 49 | 20 | 60 | G11231 | G11231B |
| G(PF)2" | 37-44 | 50 | 20 | 65 | G20044 | G20044B |
| G(PF)2" | 29-35 | 50 | 20 | 65 | G20035 | G20035B |
| G(PF)2" | 25-30,5 | 50 | 20 | 65 | G20030 | G20030B |
| G(PF)2" | 30,5-40 | 50 | 20 | 65 | G20040 | G20040B |

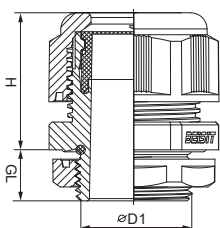

Металлический кабельный ввод тип G (PF)
G(PF) Type Metal Cable Glands



Материал: Никелированная латунь
Зажим: PA (NYLON), UL 94 V-2
Уплотнение: NBR, (EPDM, TPV, силикон)
Кольцо: EPDM
Температура: -40 °C to 100 °C
Под заказа: с другой резьбой: G(BSP), PF, PS, NPT

Material: Nickel-plated brass
Fixture pack: PA (NYLON), UL 94 V-2
Hermetic seal: NBR, (EPDM Upon Request)
O-Ring: EPDM
Temperature: -40°C to 100°C
Note: Other screw thread type G(BSP),PF,PS, NPT can be supplied as request



| Thread Ø D1 | mm | H mm | GL mm | mm | Beisit No. |
|----------------|-------|---------|----------|-------|------------|
| G(PF)1/4" | 3-6.5 | 19 | 8 | 14 | G1407BR |
| G(PF)1/4" | 2-5 | 19 | 8 | 14 | G1405BR |
| G(PF)3/8" | 4-8 | 21 | 9 | 17/19 | G3808BR |
| G(PF)3/8" | 2-6 | 21 | 9 | 17/19 | G3806BR |
| G(PF)1/2" | 6-12 | 23 | 9 | 22 | G1212BR |
| G(PF)1/2" | 5-9 | 23 | 9 | 22 | G1209BR |
| G(PF)1/2" | 10-14 | 24 | 9 | 24 | G1214BR |
| G(PF)3/4" | 13-18 | 25 | 12 | 30 | G3418BR |
| G(PF)3/4" | 9-16 | 25 | 12 | 30 | G3416BR |
| G(PF)1" | 18-25 | 31 | 12 | 40 | G10025BR |
| G(PF)1" | 13-20 | 31 | 12 | 40 | G10020BR |
| G(PF)1 1/4" | 22-32 | 37 | 15 | 50 | G11432BR |
| G(PF)1 1/4" | 20-26 | 37 | 15 | 50 | G11426BR |

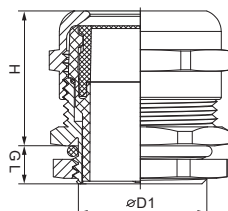

Металлический кабельный ввод тип G (PF) усиленный
G(PF) Metal Cable Gland-Reinforced Type



Материал: Никелированная латунь
Зажим: PA (NYLON), UL 94 V-2
Уплотнение: NBR, (EPDM, TPV, силикон)
Кольцо: EPDM
Температура: -40 °C to 100 °C

Material: Nickel-plated brass
Fixture pack: PA (NYLON), UL 94 V-2
Hermetic seal: NBR, (EPDM Upon Request)
O-Ring: EPDM
Temperature: -40°C to 100°C



| Thread Ø D1 | mm | H mm | GL mm | mm | Beisit No. |
|----------------|-------|---------|----------|----|------------|
| G(PF)1/4" | 3-6.5 | 19 | 8 | 14 | G1407BR-R |
| G(PF)1/4" | 2-5 | 19 | 8 | 14 | G1405BR-R |
| G(PF)3/8" | 5-10 | 22 | 9 | 20 | G3810BR-R |
| G(PF)3/8" | 3-7 | 22 | 9 | 20 | G3807BR-R |
| G(PF)1/2" | 10-14 | 24 | 9 | 24 | G1214BR-R |
| G(PF)1/2" | 7-12 | 24 | 9 | 24 | G1212BR-R |
| G(PF)3/4" | 13-18 | 25 | 12 | 30 | G3418BR-R |
| G(PF)3/4" | 9-16 | 25 | 12 | 30 | G3416BR-R |
| G(PF)1" | 18-25 | 31 | 12 | 40 | G10025BR-R |
| G(PF)1" | 13-20 | 31 | 12 | 40 | G10020BR-R |
| G(PF)1 1/4" | 22-32 | 37 | 15 | 50 | G11432BR-R |
| G(PF)1 1/4" | 20-26 | 37 | 15 | 50 | G11426BR-R |
| G(PF)1 1/2" | 32-38 | 37 | 15 | 57 | G11238BR-R |
| G(PF)1 1/2" | 25-31 | 37 | 15 | 57 | G11231BR-R |
| G(PF)2" | 37-44 | 38 | 15 | 64 | G20044BR-R |
| G(PF)2" | 29-35 | 38 | 15 | 64 | G20035BR-R |

